

Outpatient Guide

《英語版》

First Floor Ground Plan

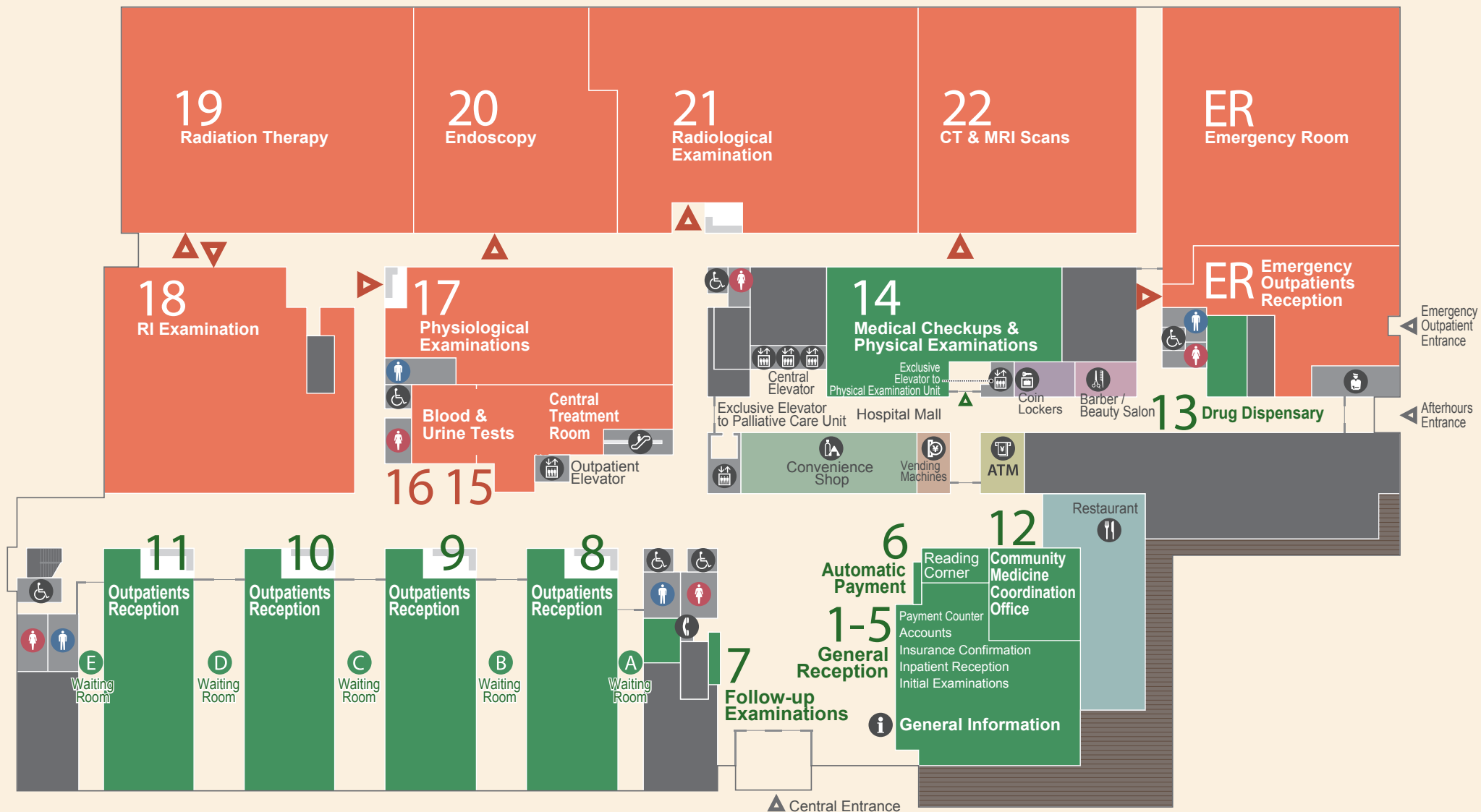

- 8 Reception: Pediatric / Otolaryngology - Head & Neck Surgery
- 9 Reception: Internal Medicine - Geriatrics / Diabetes - Endocrinology / Neurology / Neurosurgery / Gastroenterology / Nephrology / Rheumatology
- 10 Reception: Cardiovascular Medicine / Cardiovascular Surgery / Respiratory Medicine / Thoracic Surgery / Pain Clinic
- 11 Reception: Orthopaedics / Surgery / Hematology - Medical Oncology / Psychiatry